

# 687.5640 camera module

Custom OV5640 MIPI camera 687.5640A

- [Overview](#)
- [Pinout](#)
- [Dimensions](#)
- [Revision history](#)

# Overview

Custom interface board and OV5640 camera module

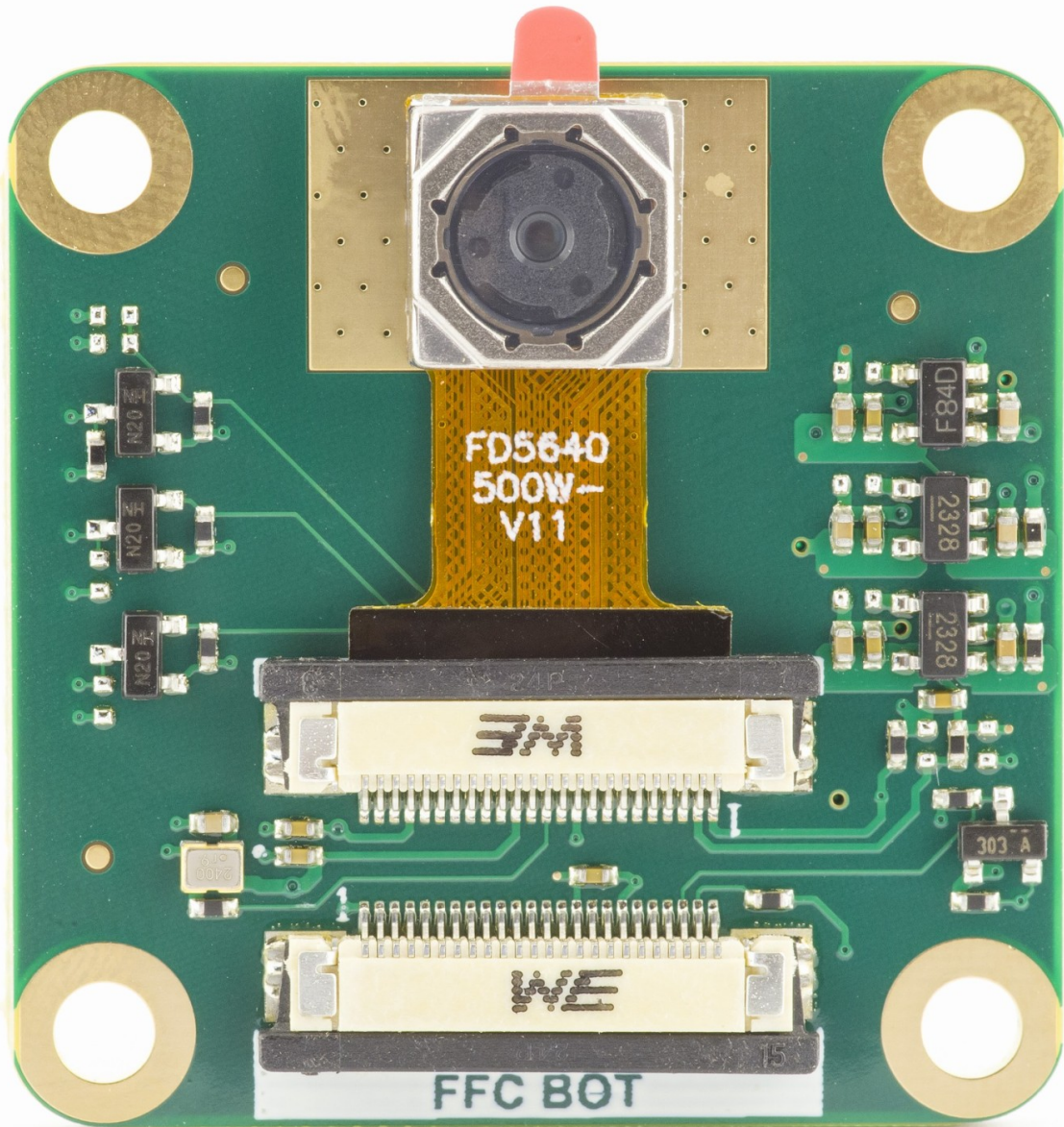

# Pinout

Interface connector 24pin 0.5mm pitch 68712414522 from Würth Elektronik.

Pin	Signal	Description
1	GND	
2	CSI_D0_N	
3	CSI_D0_P	
4	GND	
5	CSI_D1_N	
6	CSI_D1_P	
7	GND	
8	CSI_CLK_N	
9	CSI_CLK_P	
10	GND	
11	CSI_GPIO0_RST	
12	CAM1_MCLK	
13	SCL	
14	SDA	
15	3.3V	Camera power supply
16	N.C.	
17	N.C.	
18	GND	

19	N.C.	
20	N.C.	
21	5V	Used for LED
22	CSI_GPIO1	Camera Sensor Power Down
23	CSI_GPIO2	Camera Sensor Identification
241	CSI_GPIO3	Power Supply Control

# Dimensions

- Board dimensions: 35 x 35 x 6.6mm
- Weight: 5.5g

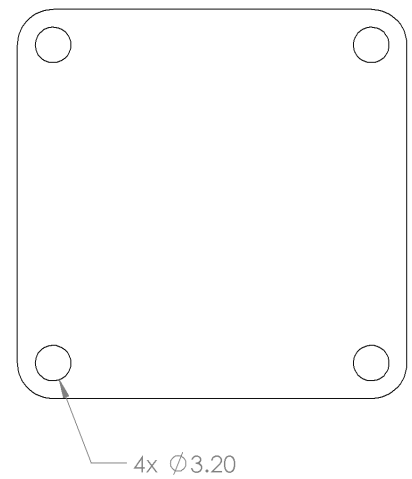
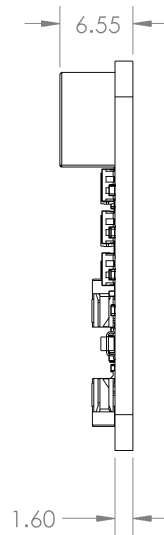
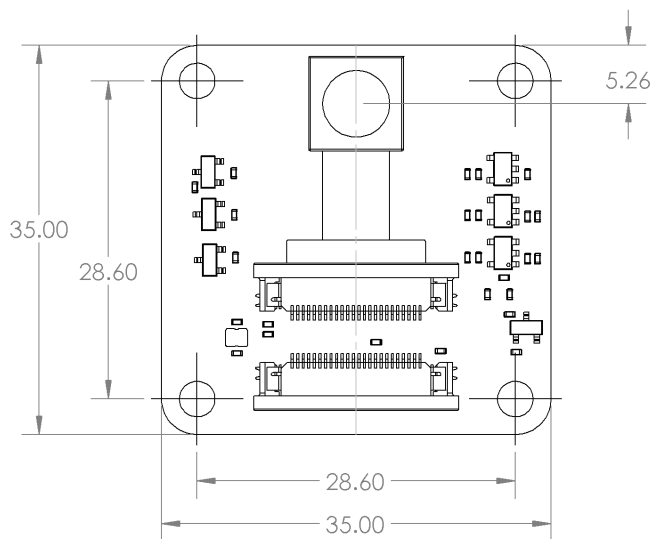

# Revision history

Revision	Date	Notes
revA / 687.5640A	2022-08-01	Initial revision