

# L049-50-M12

## Description

50mm M12 low distortion lens



## Specifications

Focal Length	50mm
Aperture	f/2.5
Image Size	1/2"
Angle of View	H: 7.3°
Mount Type	<b>M12</b> x 0.5-6g
Minimum Object Distance	0.1m
Back focal length	17.18mm
External Dimensions	<ul style="list-style-type: none"><li>• D=25mm</li><li>• L=48.8mm</li></ul>
Net Weight	37g

# Dimensions

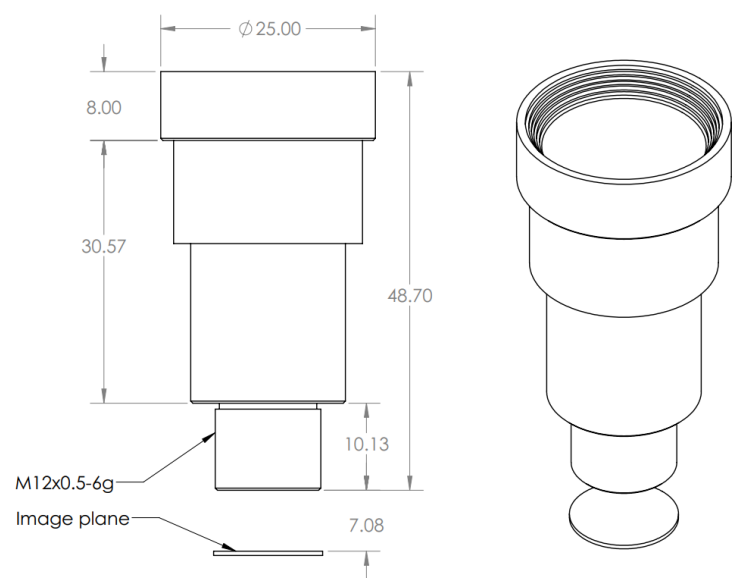

Revision #1  
Created 6 January 2025 07:36:02 by Saulius  
Updated 28 May 2025 08:03:00 by Saulius