

LP0508-P0050 - IR CUT filter

This filter is designed and manufactured for C1, C1 PRO, C920 and Brio reworked cameras but can be used for all other applications (like astronomy). It is used to block IR and UV light.

Dimensions

- Diameter: 19.0+/-0.1mm
- Thickness: 1.0+/-0.1mm

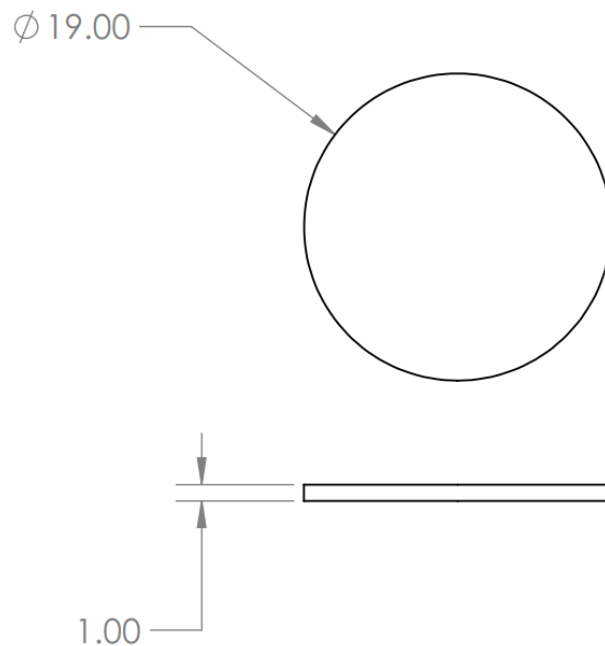

Specifications

- Coating: AR+UV+IR block
- Transmittance(avg) > 90%@370 -650nm
- OD value: >2@750-1050nm

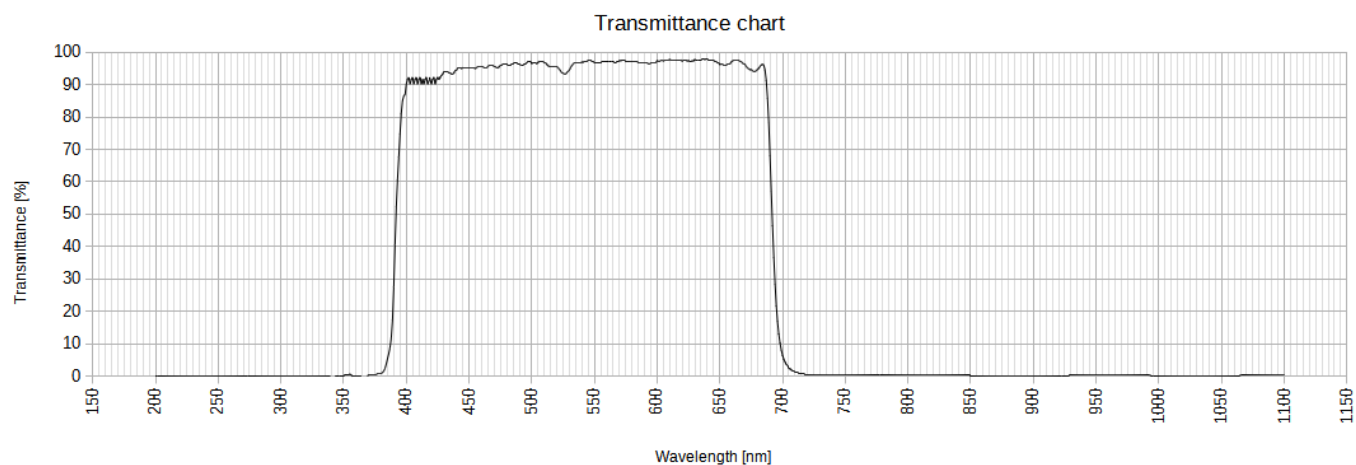

Revision #2

Created 7 January 2022 12:16:42 by Saulius

Updated 7 January 2022 12:21:26 by Saulius