

# Lens specifications

## Specifications

Focal Length	5-50mm
Aperture	f/2.0
Image Size	1/2.7?
Mount Type	D14
Minimum Object Distance	≥1m
Back Focal Length	6.87mm
Operation Mode Iris	Fixed
Operation Mode Focus	Stepper motor
Operation Mode Zoom	Stepper motor
External Dimensions	<ul style="list-style-type: none"><li>• Diameter: 30mm</li><li>• Length: 52.5mm</li></ul>
Weight	136g

## Drawings

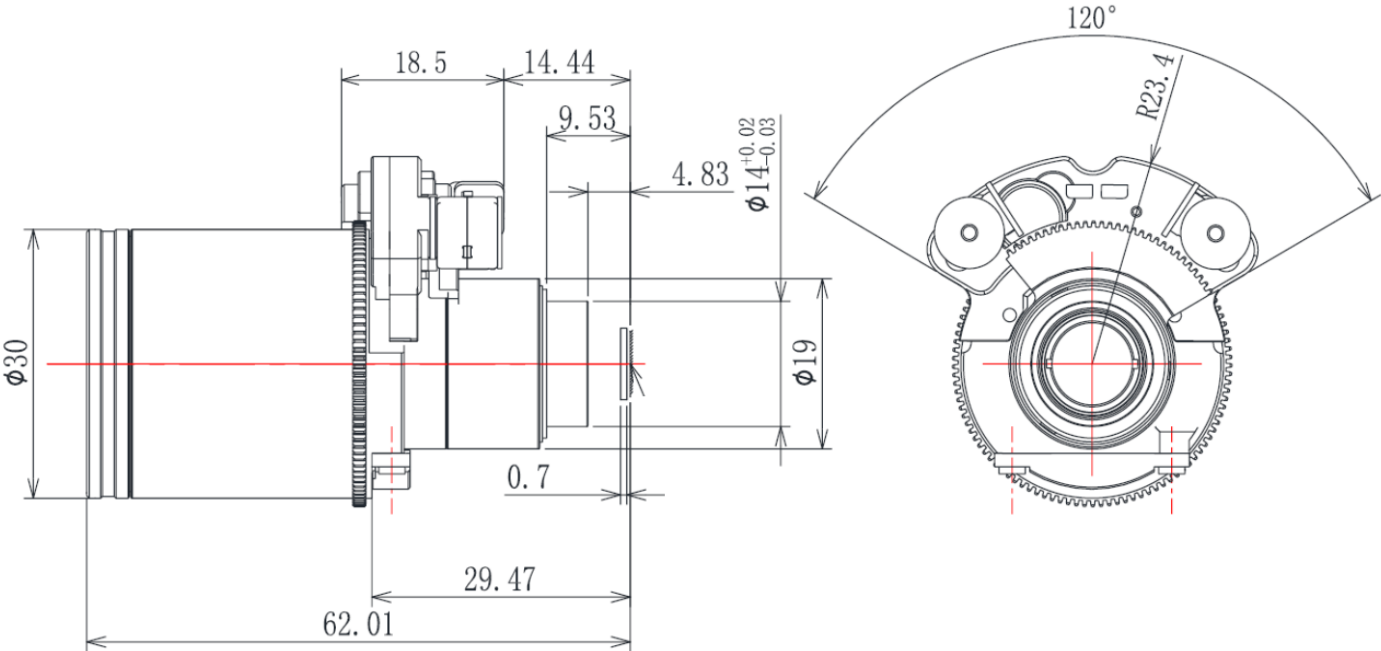

## Wiring

Wire Nr	Wire color	Operation group	Motor signal
---------	------------	-----------------	--------------

1	Blue	Focus	A-
2	Black	Focus	A+
3	Green	Zoom	A-
4	Orange	Zoom	A+
5	Yellow	Zoom	B+
6	Purple	Zoom	B-
7	White	Focus	B-
8	Red	Focus	B+

## Motor specifications

Step Motor Outside diameter	8mm
Phase count	2 phase (Bipolar)
Coil Resistance	40 $\Omega$ / phase $\pm$ 10%
Current	120-140mA (3.3-5V)
Step angle	18 degrees/step
Inductance	2m H REF(at 25 $^{\circ}$ 1KHZ, 1.0Vrms)
Operating temperature	-20 $^{\circ}$ to 60 $^{\circ}$
Zoom range steps	2342 Steps 0.0076mm/Steps
Focus range steps	2342 Steps 0.0022mm/Steps

Revision #3

Created 30 July 2020 12:04:40 by Saulius

Updated 10 August 2020 13:36:40 by Saulius